

**SECTION A-A**

(TWO-WAY TANGENT)  
SCALE : 1/4" = 1'-0"

FOR REBAR AND DIMENSIONS NOT SHOWN, SEE DETAILS "A", "C" OR "D"  
△ UNLESS OTHERWISE NOTED IN PLANS

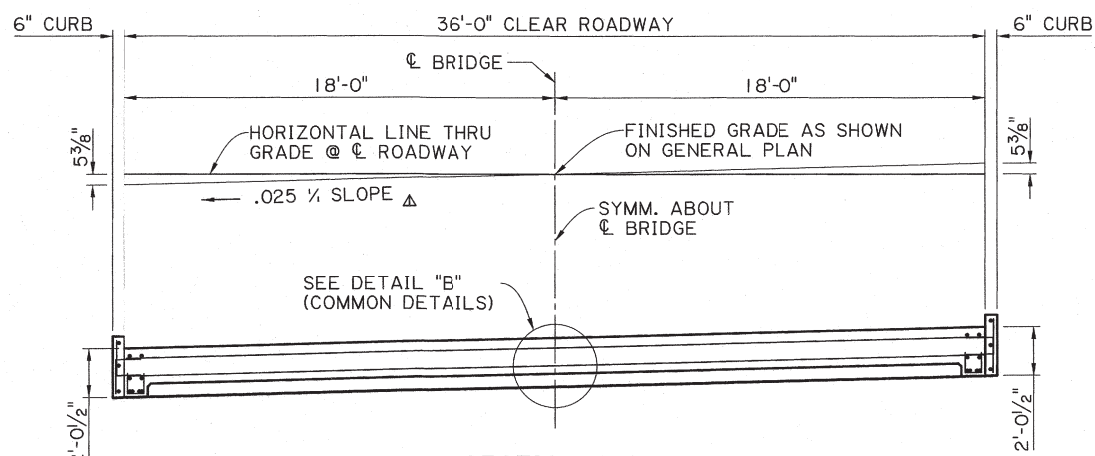

**SECTION A-A**

(ONE-WAY TANGENT)  
SCALE : 1/4" = 1'-0"

SEE TWO-WAY TANGENT FOR REINFORCEMENT DETAILS  
△ UNLESS OTHERWISE NOTED IN PLANS

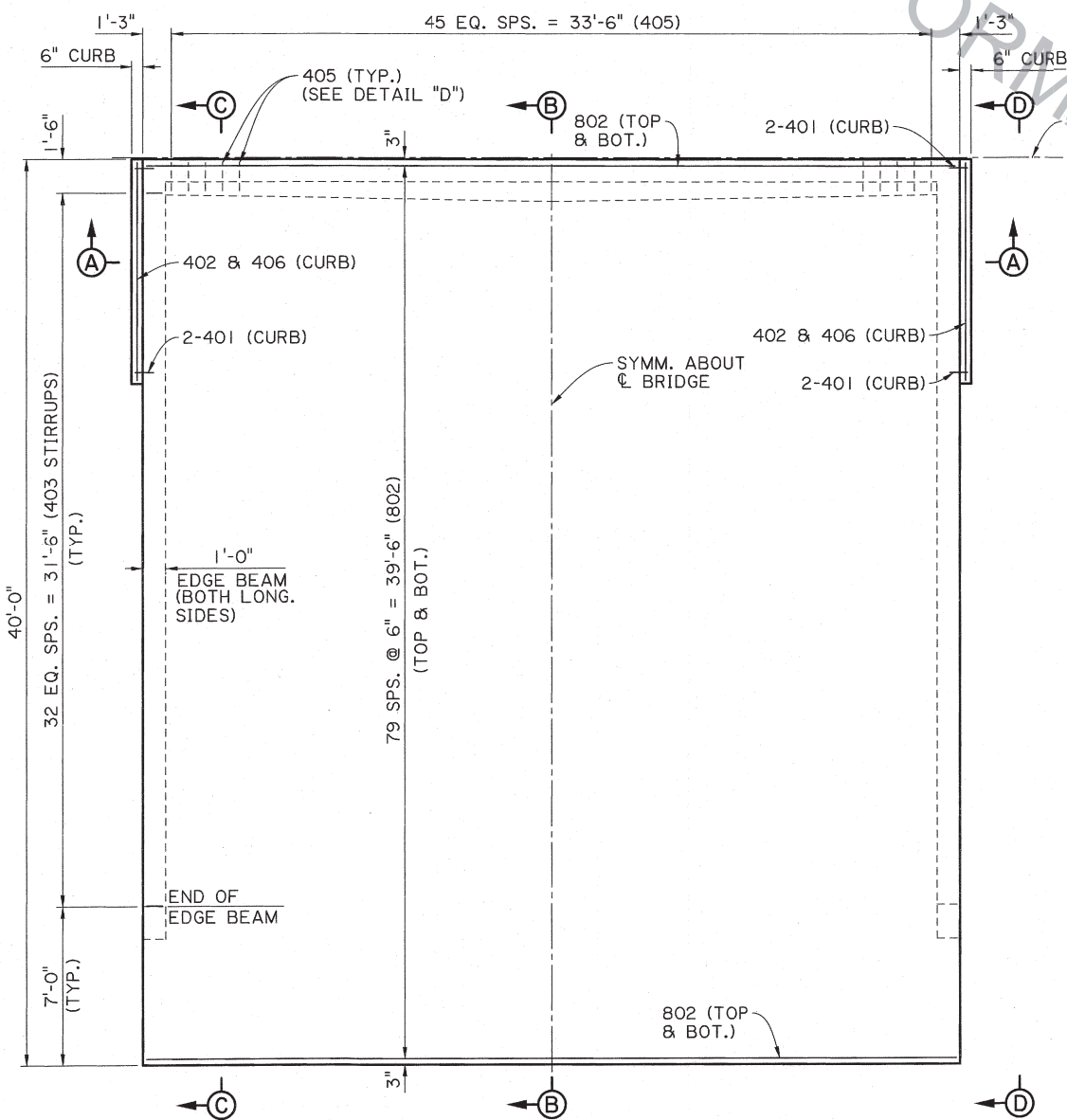

**PLAN (0° SKEW)**

SCALE : 1/4" = 1'-0"

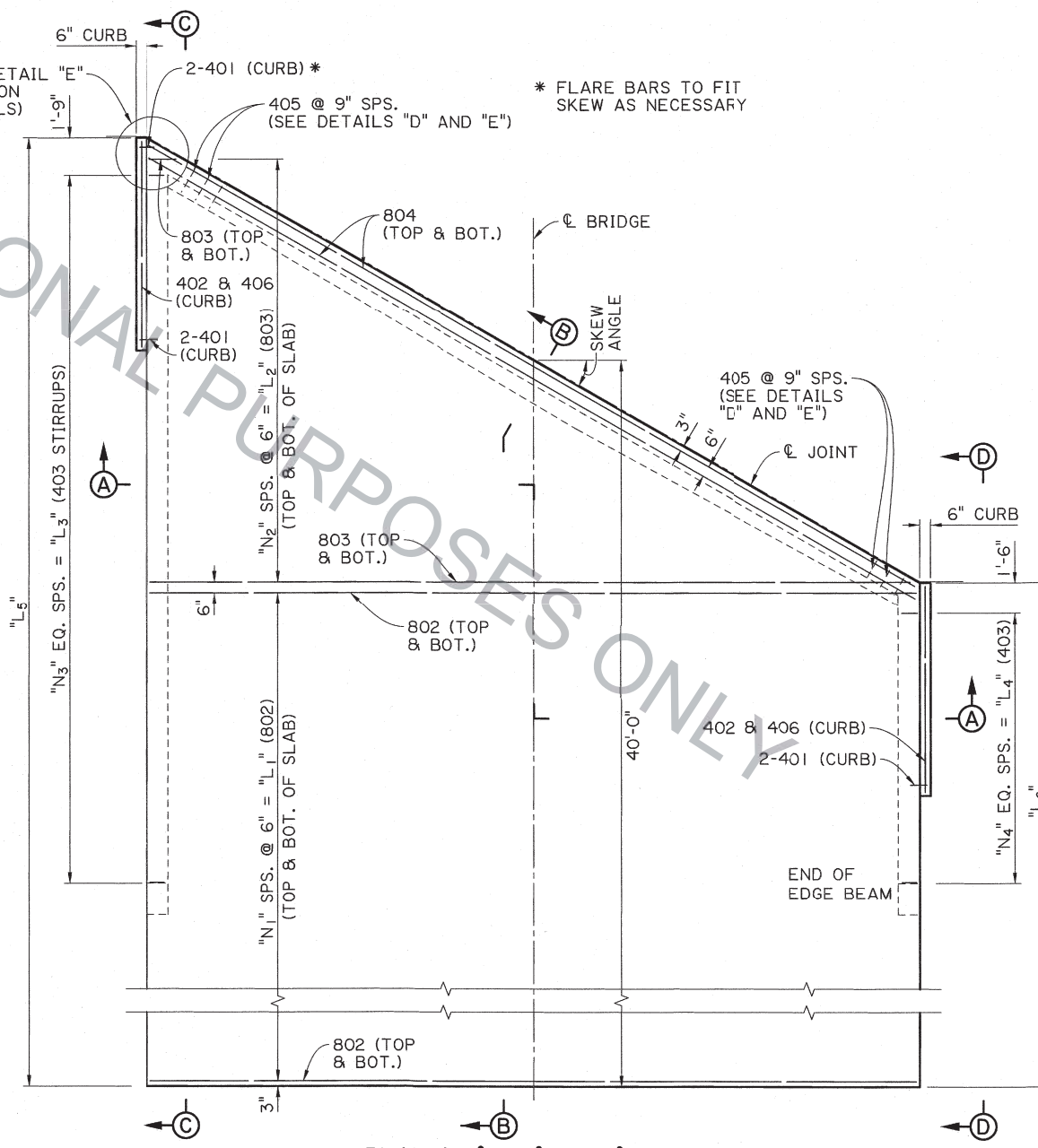

**PLAN (15°, 30° & 45° SKEW)**

(N.T.S.)  
(30° SKEW SHOWN, SEE SHT. 2 OF 2 FOR VARIABLES)

**NOTE:**

SEE APPROACH SLAB COMMON DETAILS FOR SECTIONS AND DETAILS NOT SHOWN.



Adam Lancaster  
6/19/17

SHEET NUMBER	PARISH	CONTROL SECTION	STATE PROJECT
DESIGNED A. LANCASTER	CHECKED R. MORVANT	REVIEWED Z.Z. FU	SERIES # 1 OF 2
DATE	NO.	NO.	NO.
REVISION OR CHANGE ORDER DESCRIPTION			
BY			
<p><b>APPROACH SLAB DETAILS</b>  <b>40' LONG &amp; 36' CLEAR ROADWAY</b>                  SLAB SPANS AND QUAD BEAM BRIDGES                  BD.2.10.2.5.01 - APPROACH SLAB</p>			
BRIDGE AND STRUCTURAL DESIGN			

ESTIMATED QUANTITIES (ONE 0° SKEWED APPROACH SLAB)						
BAR	NO.	SHORT BAR	VAR. (IN.)	LONG BAR	TOTAL LENGTH	LOCATION
1001	72	-	-	39'-8"	2856'-0"	LONG. IN BOT. OF SLAB
1002	4	-	-	32'-10"	131'-4"	BOTTOM OF EDGE BEAMS
1003	4	-	-	32'-10"	131'-4"	BOTTOM OF EDGE BEAMS
-	-	-	-	-	-	-
-	-	-	-	-	-	-
TOTAL NO. 10 BARS = 3118'-8" = 13,420 LBS						
801	72	-	-	39'-8"	2856'-0"	LONG. IN TOP OF SLAB
802	160	-	-	35'-8"	5706'-8"	TRANSV. IN TOP & BOT. OF SLAB
-	-	-	-	-	-	-
-	-	-	-	-	-	-
-	-	-	-	-	-	-
-	-	-	-	-	-	-
-	-	-	-	-	-	-
TOTAL NO. 8 BARS = 8562'-8" = 22,862 LBS						
501	14	-	-	35'-8"	499'-4"	TOP & BOT. OF SLEEPER SLAB
502	96	-	-	4'-8"	448'-0"	TOP & BOT. OF SLEEPER SLAB
TOTAL NO. 5 BARS = 947'-4" = 988 LBS						
401	44	-	-	2'-7"	113'-8"	DOWELS IN CURBS
402	2	-	-	13'-1"	26'-2"	LONG. IN CURBS
403	66	-	-	2'-2"	143'-0"	STIRRUPS IN EDGE BEAMS
404	2	-	-	35'-8"	71'-4"	BOTTOM OF HAUNCH
405	46	-	-	4'-8"	214'-8"	STIRRUPS IN HAUNCH
406	4	-	-	13'-2"	52'-8"	LONG. IN CURBS
TOTAL NO. 4 BARS = 621'-6" = 415 LBS						
TOTAL DEFORMED REINFORCING STEEL					37,685 LBS.	
CONCRETE APPROACH SLAB					1440 SQ. FT.	

ESTIMATED QUANTITIES (ONE 30° SKEWED APPROACH SLAB)						
BAR	NO.	SHORT BAR	VAR. (IN.)	LONG BAR	TOTAL LENGTH	LOCATION
1001	72	29'-4"	3.46"	49'-10"	2850'-0"	LONG. IN BOT. OF SLAB
1002	4	-	-	42'-9"	171'-0"	BOTTOM OF EDGE BEAMS
1003	4	-	-	22'-6"	90'-0"	BOTTOM OF EDGE BEAMS
-	-	-	-	-	-	-
-	-	-	-	-	-	-
TOTAL NO. 10 BARS = 3111'-0" = 13,387 LBS						
801	72	29'-4"	3.46"	49'-10"	2850'-0"	LONG. IN TOP OF SLAB
802	118	-	-	35'-8"	4208'-8"	TRANSV. IN TOP & BOT. OF SLAB
803	78	2'-4"	10.39"	35'-3"	1465'-9"	TRANSV. IN TOP & BOT. OF SLAB
804	4	-	-	41'-2"	164'-8"	TOP & BOT. OF SLAB ALONG SKEW
-	-	-	-	-	-	-
-	-	-	-	-	-	-
-	-	-	-	-	-	-
TOTAL NO. 8 BARS = 8689'-01" = 23,200 LBS						
501	14	-	-	35'-8"	499'-4"	TOP & BOT. OF SLEEPER SLAB
502	96	-	-	4'-8"	448'-0"	TOP & BOT. OF SLEEPER SLAB
TOTAL NO. 5 BARS = 947'-4" = 988 LBS						
401	44	-	-	2'-7"	113'-8"	DOWELS IN CURBS
402	2	-	-	13'-1"	26'-2"	LONG. IN CURBS
403	66	-	-	2'-2"	143'-0"	STIRRUPS IN EDGE BEAMS
404	2	-	-	42'-11"	85'-10"	BOTTOM OF HAUNCH
405	53	-	-	4'-8"	247'-4"	STIRRUPS IN HAUNCH
406	4	-	-	13'-2"	52'-8"	LONG. IN CURBS
TOTAL NO. 4 BARS = 668'-8" = 447 LBS						
TOTAL DEFORMED REINFORCING STEEL					38,022 LBS.	
CONCRETE APPROACH SLAB					1440 SQ. FT.	

ESTIMATED QUANTITIES (ONE 15° SKEWED APPROACH SLAB)						
BAR	NO.	SHORT BAR	VAR. (IN.)	LONG BAR	TOTAL LENGTH	LOCATION
1001	72	34'-10"	1.62"	44'-5"	2853'-0"	LONG. IN BOT. OF SLAB
1002	4	-	-	37'-5"	149'-8"	BOTTOM OF EDGE BEAMS
1003	4	-	-	28'-1"	112'-4"	BOTTOM OF EDGE BEAMS
-	-	-	-	-	-	-
-	-	-	-	-	-	-
TOTAL NO. 10 BARS = 3115'-0" = 13,404 LBS						
801	72	34'-10"	1.62"	44'-5"	2853'-0"	LONG. IN TOP OF SLAB
802	140	-	-	35'-8"	4993'-4"	TRANSV. IN TOP & BOT. OF SLAB
803	36	3'-2"	22.41"	34'-11"	685'-6"	TRANSV. IN TOP & BOT. OF SLAB
804	4	-	-	36'-11"	147'-8"	TOP & BOT. OF SLAB ALONG SKEW
-	-	-	-	-	-	-
-	-	-	-	-	-	-
-	-	-	-	-	-	-
TOTAL NO. 8 BARS = 8679'-6" = 23,174 LBS						
501	14	-	-	35'-8"	499'-4"	TOP & BOT. OF SLEEPER SLAB
502	96	-	-	4'-8"	448'-0"	TOP & BOT. OF SLEEPER SLAB
TOTAL NO. 5 BARS = 947'-4" = 988 LBS						
401	44	-	-	2'-7"	113'-8"	DOWELS IN CURBS
402	2	-	-	13'-1"	26'-2"	LONG. IN CURBS
403	65	-	-	2'-2"	140'-10"	STIRRUPS IN EDGE BEAMS
404	2	-	-	36'-11"	73'-10"	BOTTOM OF HAUNCH
405	47	-	-	4'-8"	219'-4"	STIRRUPS IN HAUNCH
406	4	-	-	13'-2"	52'-8"	LONG. IN CURBS
TOTAL NO. 4 BARS = 626'-6" = 419 LBS						
TOTAL DEFORMED REINFORCING STEEL					37,985 LBS.	
CONCRETE APPROACH SLAB					1440 SQ. FT.	

ESTIMATED QUANTITIES (ONE 45° SKEWED APPROACH SLAB)						
BAR	NO.	SHORT BAR	VAR. (IN.)	LONG BAR	TOTAL LENGTH	LOCATION
1001	72	21'-10"	6.0"	57'-4"	2850'-0"	LONG. IN BOT. OF SLAB
1002	4	-	-	50'-0"	200'-0"	BOTTOM OF EDGE BEAMS
1003	4	-	-	15'-0"	60'-0"	BOTTOM OF EDGE BEAMS
-	-	-	-	-	-	-
-	-	-	-	-	-	-
TOTAL NO. 10 BARS = 3110'-0" = 13,382 LBS						
801	72	21'-10"	6.0"	57'-4"	2850'-0"	LONG. IN TOP OF SLAB
802	88	-	-	35'-8"	3138'-8"	TRANSV. IN TOP & BOT. OF SLAB
803	136	1'-10"	6.0"	35'-4"	2527'-4"	TRANSV. IN TOP & BOT. OF SLAB
804	4	-	-	50'-5"	201'-8"	TOP & BOT. OF SLAB ALONG SKEW
-	-	-	-	-	-	-
-	-	-	-	-	-	-
-	-	-	-	-	-	-
TOTAL NO. 8 BARS = 8717'-8" = 23,276 LBS						
501	14	-	-	35'-8"	499'-4"	TOP & BOT. OF SLEEPER SLAB
502	96	-	-	4'-8"	448'-0"	TOP & BOT. OF SLEEPER SLAB
TOTAL NO. 5 BARS = 947'-4" = 988 LBS						
401	44	-	-	2'-7"	113'-8"	DOWELS IN CURBS
402	2	-	-	13'-1"	26'-2"	LONG. IN CURBS
403	66	-	-	2'-2"	143'-0"	STIRRUPS IN EDGE BEAMS
404	2	-	-	52'-2"	104'-4"	BOTTOM OF HAUNCH
405	65	-	-	4'-8"	303'-4"	STIRRUPS IN HAUNCH
406	4	-	-	13'-2"	52'-8"	LONG. IN CURBS
TOTAL NO. 4 BARS = 743'-2" = 496 LBS						
TOTAL DEFORMED REINFORCING STEEL					38,143 LBS.	
CONCRETE APPROACH SLAB					1440 SQ. FT.	

NOTES:

- 1. QUANTITIES SHOWN FOR 401, 402 AND 406 BARS ARE FOR A 13'-6" CURB (SEE APPROACH SLAB DETAIL "P"). ADJUST QUANTITIES AS NEEDED FOR LONGER CURBS OR FOR "BRIDGE END DRAIN SYSTEM" INSTALLATIONS. BRIDGES WITHOUT GUARDRAIL OR END DRAINS DO NOT REQUIRE A CURB, UNLESS OTHERWISE STATED IN THE PLANS.
- 2. ALL MATERIAL TO BE PAID FOR UNDER ITEM "CONCRETE APPROACH SLABS (CAST-IN-PLACE)." QUANTITIES ARE FOR INFORMATION PURPOSES ONLY.
- 3. FOR HANDLING PURPOSES, #4 BARS OVER 40' MAY BE SPLICED WITH A 1'-9" MIN. LAP SPLICE. ALL SPLICES TO BE STAGGERED. (1'-9" SPLICE INCLUDED IN ESTIMATED QUANTITIES.)

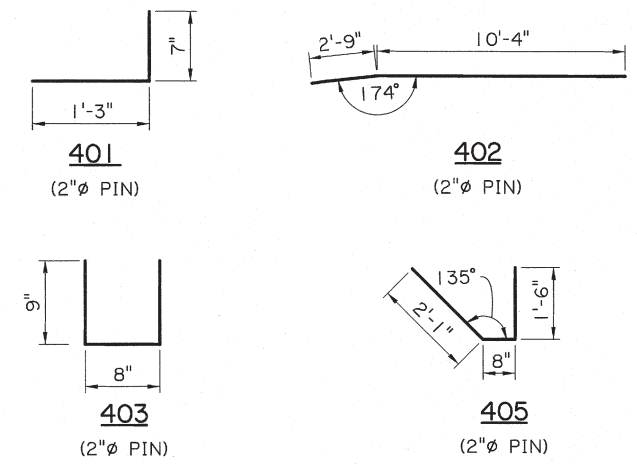

VARIABLES (SEE PLAN VIEW, SHT. 1 OF 2)			
VARIABLE	15° SKEW	30° SKEW	45° SKEW
N <sub>1</sub>	69	58	43
N <sub>2</sub>	17	38	67
N <sub>3</sub>	36	42	50
N <sub>4</sub>	27	22	14
L <sub>1</sub>	34'-6"	29'-0"	21'-6"
L <sub>2</sub>	8'-6"	19'-0"	33'-6"
L <sub>3</sub>	36'-1"	41'-8"	49'-3"
L <sub>4</sub>	26'-8"	21'-1"	13'-6"
L <sub>5</sub>	44'-10"	50'-4 3/4"	58'-0"
L <sub>6</sub>	35'-2"	29'-7 1/4"	22'-0"

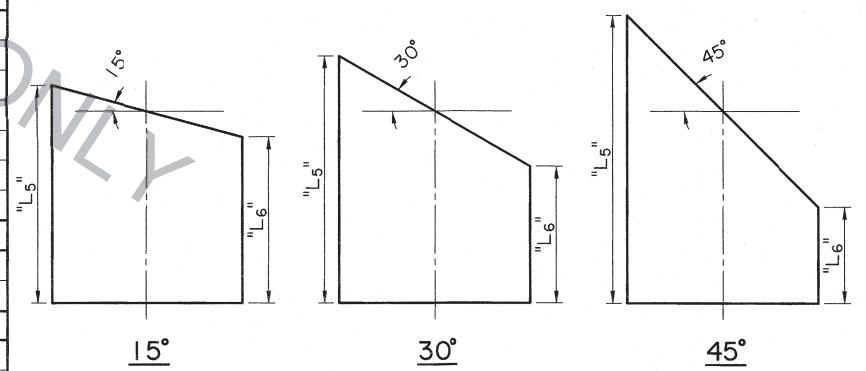

SHEET NUMBER

DESIGNED: A. LANCASTER  
CHECKED: R. MORVANT  
DATE: 6/19/17

CONTROL SECTION: A. LANCASTER  
CHECKED: R. MORVANT  
DATE: 6/19/17

STATE PROJECT: Z.Z. FU  
SERIES # 2 OF 2

REVISION OR CHANGE ORDER DESCRIPTION

DATE

NO.

BY

APPROACH SLAB QUANTITIES  
40' LONG & 36' CLEAR ROADWAY  
SLAB SPANS AND QUAD BEAM BRIDGES

BD.2.10.2.5.02 - APPROACH SLAB

BRIDGE AND STRUCTURAL DESIGN

